

These are the benefits

- Decrease of print costs and increase of business and user efficiency
- Documents follow users to their choice of printer
- Tracking of print and copy activity
- Any public workgroup printer is turned into a personal printer
- Utilization of printers is optimized
- Ready for enterprise-wide and mission critical printing
- Quota and fee-based printing and copying solution

A balanced deployment of SafeCom enabled workgroup printers and modern Multi Function Printers (MFPs) combined with the SafeCom G2 server software helps any company or organization decrease print costs and increase business and user efficiency.

How does it work

SafeCom is a modular system that can be enhanced with add-on modules to build customer specific and scalable solutions. Users can walk up to any SafeCom-enabled printer, identify themselves and collect their documents (Pull Print). On MFPs, users identify themselves the same way to access copying (Copy Control), fax, scan and e mail.

SafeCom can track data about SafeCom print and copy jobs, including; owner, number of pages, paper size, and possible use of color and duplex. Documents that are printed directly to printers (Push Print) can also be tracked (no need for special hardware at the printers). SafeCom Tracking is the basis for invoicing users, departments or customers (SafeCom Client Billing) based on actual number of prints and copies. Tracking data can also be of use if printer fleet management is outsourced on a pay-per-use basis.

With SafeCom Pay users can be made to prepay for printing and copying. Users are prevented from printing and copying if the balance of their account goes below a specified limit.

SafeCom Rule Based Printing provides the ability to enforce rules for printing ensuring higher savings.

Characteristics

- **Cost-efficient:** Recorded data can be used for subsequent invoicing. Balanced deployment of devices using cost-efficient workgroup printers for personal printing and optional Rule Based Printing.
- **Secure:** User identification at the printer by means of a card and/or code means no jeopardizing of document security. Print data is protected on the network with optional encryption.
- **Flexible:** Documents follow users to their choice of printer, letting users roam between locations. If a printer is down users can simply login at another printer.
- **Controlled:** Tracking of print and copy usage. On MFPs users can be asked to identify themselves before access is granted to copying.
- **Scalable:** Solutions enable multiple servers in various locations to work together to support as many printers and users as required.
- **Enterprise ready:** Central solution management and support for mission critical printing with Microsoft Cluster Service support.
- **Revenue generating:** Possible to demand up-front payment for printing and copying; users can deposit money to their account either on the Internet via SafeCom ePay or by depositing notes and coins in the SafeCom Money Loader.
- **Dual charging scheme:** A device can be associated with two charging schemes: 1) Primary charging scheme, which is used to charge users and invoice departments, and 2) Secondary charging scheme, which is used to reflect the true costs.

Areas of application

- Banking and finance where confidentiality is top priority.
- Educational institutions and libraries in need of a quota-based and/or fee-based printing and copying solution.
- Public and NGO looking for a secure way to minimize costs.
- Advertising and consulting requiring a way to invoice clients for project related print and copy.
- Health sector units with need for secure printing of medical records.
- Outsourced printer fleet management solutions.
- Any company or organization that wants document security, decreased print costs, and increased business and user efficiency.

SafeCom a/s
Tempovej 16
DK-2750 Ballerup
Denmark

Phone: +45 4436 0240
Fax: +45 4436 0248
E-mail: info@safecom.eu
Web: safecom.eu

A Modular System

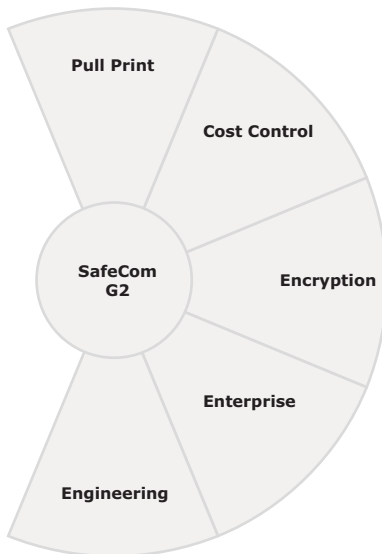

SafeCom G2

- Core server and client software.

Pull Print

- Documents follow users to their choice of printer. User identification at the printer is by means of a card and/or code.

Cost Control

- **Tracking** - Monitors print and copy usage and uses the recorded data for subsequent departmental invoicing. Printer must support PCL5, PCL5c, PCL5e, PCL6 or PostScript level 2 or 3.
- **Pay** - Is an add-on module to Tracking and allows users to pay up-front for printing and copying.

Encryption

- Protects print data on the network.

Enterprise

- **Multi Server Support** - Scalability; multiple SafeCom servers work together allowing users to roam between locations.
- **Cluster Support** - Availability; if one server fails another takes over.

Engineering

- **APIs** - Automates tasks and integrates SafeCom with other systems.
- **Development** - Customization.

System Requirements

SafeCom only requires software to be installed on a Windows server. Setup can be limited to adding or modifying one or more shared printers.

Server

Windows XP, 2003 and 2000.
SafeCom License key code.
Recommended: 1GHz CPU and 512 MB RAM. 1 GB of free disk space.

Database

The free Microsoft SQL Desktop Engine (MSDE) is distributed with SafeCom. In a SafeCom G2 multi server installation the master server must run Microsoft SQL Server on either a Windows Server 2003 or a Windows 2000 Server.

Client

Windows XP, 2003, 2000, NT 4, 98 and clients running Citrix and Windows Terminal Service.
Recommended: 400 Mhz CPU and 256 MB RAM. 100 MB of free disk space.

Network protocol

TCP/IP.

Identification Methods

Pull Print requires users to be identified at the printer. Please contact us to hear about other methods than those below:

- User code (alphanumeric)
- Magnetic Card (Track 1 & 2)
- Casi Rusco Proximity Card
- Cotag Proximity Card
- Deister Proximity Card
- EM41xx Proximity Card
- HID Proximity Card
- HITAG Proximity Card
- Indala Proximity Card
- Legic Proximity Card
- Mifare Proximity Card
- NEDAP Proximity Card
- TITAN Proximity Card
- UNIQUE Proximity Card

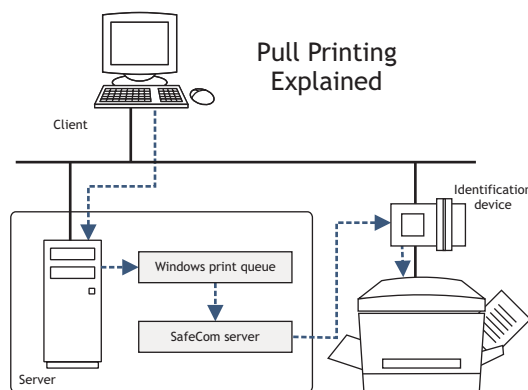

Solutions for printers & MFPs

External solution

Any printer with a parallel port (IEEE 1284) or network connection can be SafeCom-enabled with the SafeCom Controller and a standalone card reader or SafeCom Front-end (touch-screen with built-in card reader).

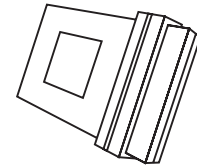

SafeCom Go

SafeCom Go is the internal solution where the user interface is integrated into the printer's menu structure. SafeCom Go is available for:

- HP
- Ricoh/NRG
- Xerox

See the list of supported devices on safecom.eu.

SafeCom Device Licenses

SafeCom Go includes authentication for copy, fax and e-mail. Order one or more of the below device licenses to get additional functionality:

- SafeCom Tracking
 - SafeCom Rule Based Printing
 - SafeCom Client Billing
 - SafeCom Pay
- SafeCom Pull Print
 - SafeCom Encryption

Refer to the corresponding data sheet for details on safecom.eu

Copy Control on MFPs

Copy Control is supported on selected MFPs from these manufactures:

- Canon
- HP
- Konica Minolta
- Kyocera Mita
- Océ
- Ricoh/NRG
- Sharp
- Xerox

The MFP must be networked and in most cases you need a special SafeCom MFP cable. For complete list please refer to *SafeCom G2 Administrator's Manual D60600*.